

MIV611弁取付例

(ガasket型)

MIV611-＊GR

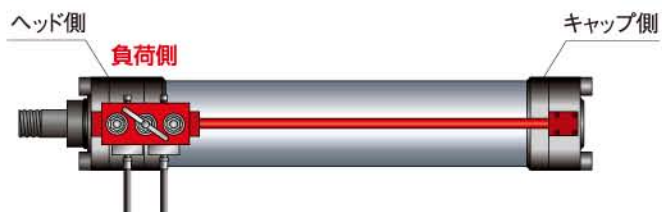

MIV611-＊GL

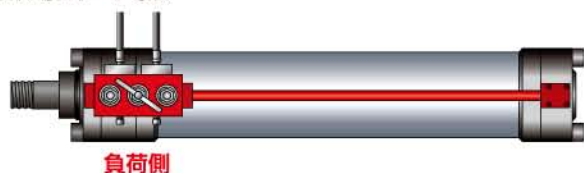

MIV611-＊GR

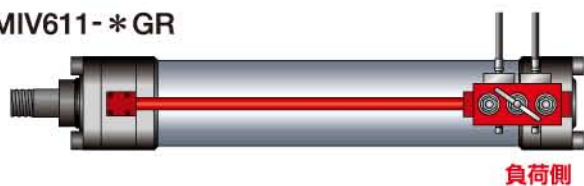

MIV611-＊GL

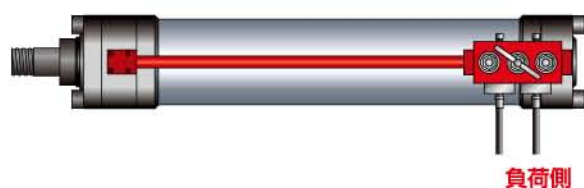

(フランジ型)

MIV611-＊F

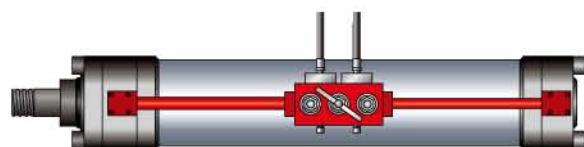
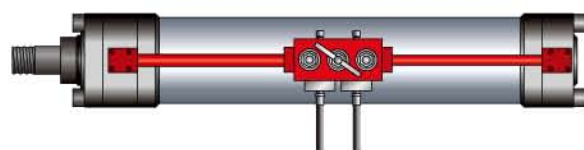

Tハンドル

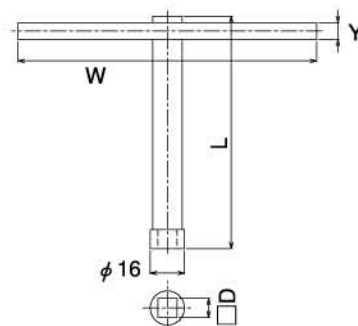

型式	D	L	W	Y	適用弁
MIV611-BH6	6	75	80	φ8	MIV611-BM01
MIV611-BH8	8	115	120	φ8	MIV611-B01,03,BM03,04
MIV611-BH9	9	115	120	φ8	MIV611-B04,06,BM06

MIV弁を油圧シリンダに取付ける場合、油圧配管破損トラブルの影響を最少に抑えるため、**負荷側**に設けてください。